



News *and* Views

Myrtle Trace

A Newsletter by Myrtle Trace Residents for Myrtle Trace Residents September 2008

BOARD BRIEFS

MONTHLY ROAD UPDATE

The latest information indicates that the backlog of other cases may put off our hearing for another six to ten weeks. The work schedule of the Special Referee is the determining factor. Our suit was filed on September 4, 2007. Now, a year later, we remain resolute, patient and prepared.

MYRTLE RIDGE CROSSING

Last month we introduced “Myrtle Ridge Crossing” in reference to the Wal Mart property development. Myrtle Ridge Crossing is a name applied to the property that is owned by and is being developed by Faison Enterprise. This is a conceptual plan that makes provision for outparcels occupied by retail shops and restaurants. Wal Mart owns the 23 acres comprising the superstore and its parking facilities. The future gas station pictured in the plan is not part of Myrtle Ridge Crossing but like Wal Mart and CVS is owned separately.

The Board has posted, in the Clubhouse enlarged copies of the Faison plan for Myrtle Ridge Crossing, the Wal Mart site plan, the landscape plan and the road improvement plan. These plans can also be found on our website. A non-detailed version of the area located between Myrtle Ridge Drive and the north boundary of the Wal Mart property is shown on one of the inner pages of this publication.

E-MAIL ADDRESSES

The Board would like to thank the residents who sent us their e-mail addresses. These addresses will only be used by the Board in cases where it is imperative to contact residents as quickly as possible. We urge those of you who have an e-mail address that is not listed in the Myrtle Trace Directory, to send your address to: “webmaster@myrtletracesc.org”. Be assured these will be kept in confidence, used only as necessary by the Board.

COME ON OUT AND CELEBRATE
THE ARRIVAL OF FALL
BY ATTENDING THE
FALL GET ACQUAINTED SOCIAL
ON SUNDAY, SEPTEMBER 14TH

**MYRTLE RIDGE CROSSING
&
WAL*MART CONCEPTUAL PLAN**

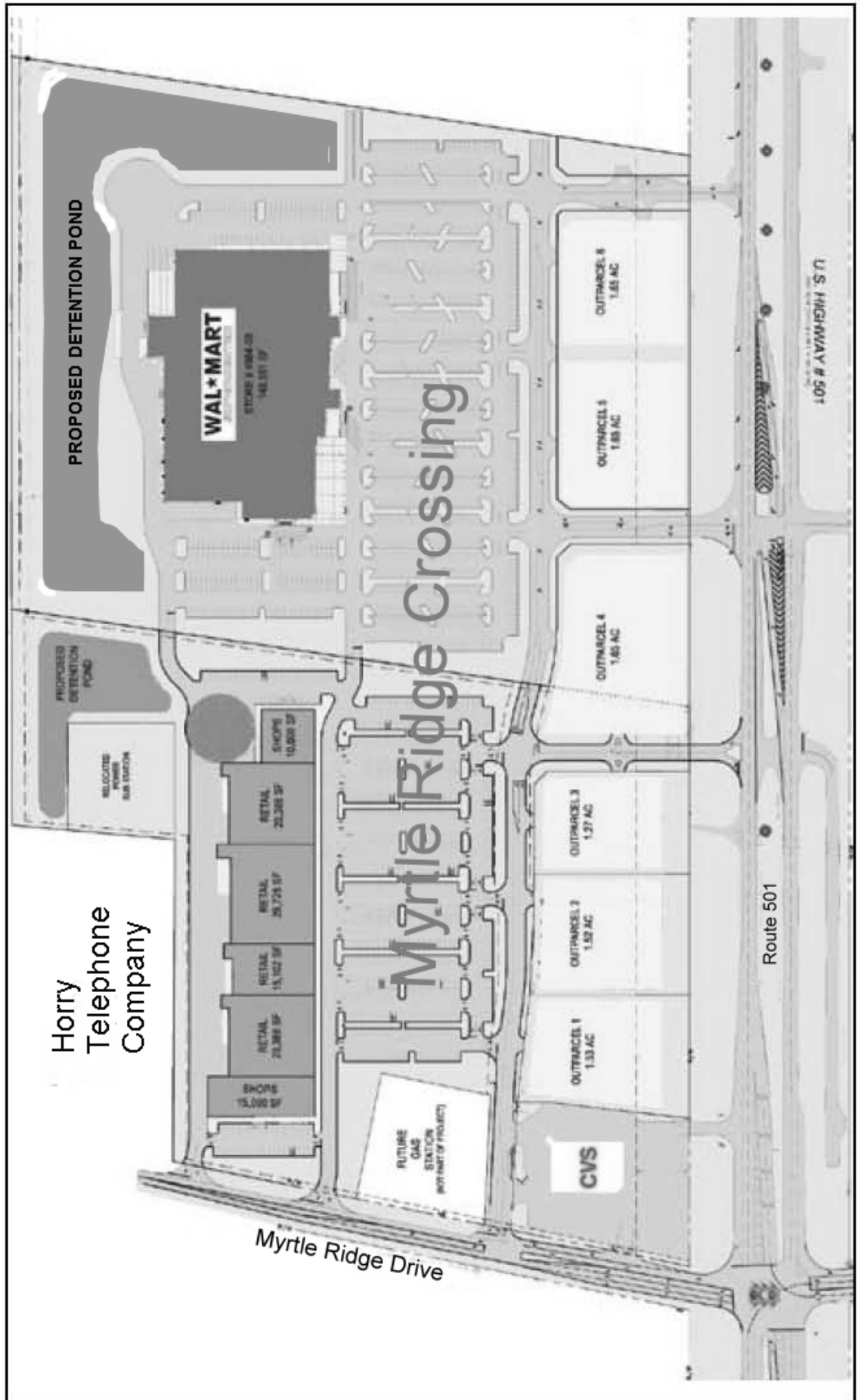

News & Views

Editor

Ted Ackley 347-3004
October Deadline - 9/20/08

Thank You

Thanking all the wonderful Myrtle Tracers who sent cards, calls, food and flowers during my "mini" down time due to surgery. I love ya all.

Charlene Rose



FREE BEGINNER COMPUTER CLASSES STARTING IN SEPTEMBER AT THE CLUBHOUSE

With an ever increasing world of electronic communications available, many of our residents are getting on board by using computers to provide access to the world around us. Many however, are not, because they don't know how or what to do and believe it is too hard to learn. The purpose of these computer classes is to change all that. We want to bring to all Myrtle Tracers these capabilities with Beginner Computer Classes. The main premise of these classes will be: "The only dumb questions are the ones not asked."

Subjects to be covered in the Beginner Classes:

Why do I need a computer? What kind of computer? How much do they cost? How do I turn to turn it on? Do I need a printer, what kind? What is the Internet? How do I get on the Internet? What information is available on the Internet? How much does the Internet Access cost? What is E-mail and how do I do it? My grandkids say they want to send me pictures, how does that happen? How to take pictures with the new electronic cameras and save money by only printing the ones you want? **What else can I do with a computer?**

As the year progresses it is hoped that we will discover other experienced users who can serve as volunteers to help our Beginners in their homes. As such, we invite experienced users to the classes, not to ask questions but to help us answer them. One thing I have learned is that every time I think I know all there is to know about computers, I discover that I was wrong. I need help.

The first class will be Monday September 8, 2008 at 7:00pm. (JUST COME)

Jim Wilkison

Webmaster

www.myrtletracesc.org

C A P

(Churches Assisting People)

CAP will hold its Annual Garage Sale on Saturday, October 4th from 8:00 am 'til noon in the parking lot behind the CAP office on Main Street in Conway.

Donations of working appliances, tools, furniture, dishes, rugs, towels, sheets or any other useful items will be appreciated.

For further information, please contact Mary or Bob

MYRTLE TRACE COMMUNITY DIRECTORY

ADDITIONS / CORRECTIONS / DELETIONS

AUGUST 23, 2008

Additions:

Cunningham, Jerome & Karen	123 Berry Tree Lane	908-251-2142
Dale, Steve & Linda	114 Hickory Drive	331-3123 NJ
Greene, Sharon	113 Birchwood Lane	457-2693
McDonald, Genie	111 Hickory Drive	685-4870

Corrections:

Chomas, William & Beverly	267-2569
---------------------------	----------

Delete:

E-Mail:

MYRTLE TRACE-MART

I WOULD LIKE TO.....

SELL - Two modern ceiling fixtures - \$15 and \$10. Please call Joyce at 347-5434. (7)

SELL - New Pampered Chef 9x13 lid/bowl/baker (\$32.00), Dualit Toaster (\$50.00), New Calphalon 10" stir fry pan (\$20.00), Nesco 4qt. roaster oven (\$10.00), Showtime Rotisserie (\$50.00). Please call George or Jane at 347-5167. (7)

SELL - Technics 2 Manual Digital Organ (SX-EN4) with pedals, automatic rhythms, bench & original manuals. Like New. Wonderful sound. A bargain. Cost \$7500. Asking \$2500 or BO. Please call Andy at 347-7067. (8)

SELL - A light blue and gray traditional style sofa bed which has a queen size mattress. Very good condition. Asking price \$100 or best offer. Call Judy @ 234-3199. (8)

SELL - Treadmill Proform Cross Walk with incline. Reduced price to \$100.00 firm. Please call Diane at 234-1499. (9)

MYRTLE TRACE-MART
is a service of the News & Views which accepts NO responsibility
for any claims made in an ad. Ads for businesses conducted by
Myrtle Trace residents will not be accepted.

ACTIVITIES COMMITTEE

Hopefully everyone has had a great summer with visits from family and friends and trips north. Your Activities Committee has been busy planning fun things for all to enjoy this year. Bingo will resume September 12th at 7 pm and the "Get Acquainted Social" is Sunday, September 14th from 3-5 pm (sign up in this issue of News and Views).

Pot Luck will be on September 15th at 5:30 pm. As ever, you are asked to bring your own service and drinks and a dish to share. Ben Powell from the Clemson Extension Office will speak at 7:00 pm re: storm water runoff and lakes. We'd like to encourage as many as possible to attend, even if you don't come for dinner. A big thank you to Rob and Terri Macker, who are the new chairpersons for Pot Luck. Mark your calendars now for "Murder Mystery & Mayhem" on October 25th. There has been tremendous response and all parts have been cast.

The next meeting of the Activities Committee will be on September 22nd at 7 pm. Anyone interested is welcome to join. All of us on the committee are looking forward to a successful and fun season.

Suzanne Owens
Mary-Frances Williams

BEVERAGE CANS

Habitat For Humanity is collecting aluminum beverage cans to earn large grants to meet their financial needs. I will be glad to serve as a central collection point for Myrtle Trace residents. I will deliver the cans to the Habitat For Humanity office.

Please leave your beverage cans in the box which will be located on my front porch at 123 Birchwood Lane. Thanks for your help.

What a simple way to assist Habitat in providing homes for those in need!

Beryl Barletta

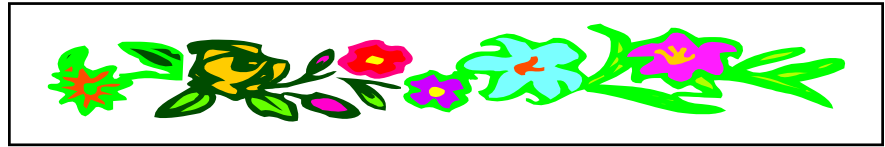

GARDEN CLUB

The recent rains have been very beneficial for the plants in the Myrtle Trace Garden as well as for bringing our ponds back to a decent level. However, the increased soil moisture levels, plus the high air temperatures led to an outbreak of two turf grass disease problems - Brown Patch of Centipede grass and Gray Leaf Spot of St. Augustine grass. Both grasses usually grow back quite well without resorting to the use of chemical controls, so be patient and resist the temptation to spray your lawn.

The Garden Club will meet at 2 pm on Thursday, September 4th at the Clubhouse. Once again, you are urged to attend and provide us with your ideas/suggestions for the improvement of the garden. With the advent of cooler, less humid (hopefully!!) weather, we will continue to have the Saturday morning (9AM) clean-up work detail where we pick up fallen limbs, pine cones and do some concentrated weed-pulling (sorry - no gold medals will be awarded in any of these categories). Your efforts shall be greatly appreciated, so please join with us on Saturday mornings whenever you have the time and energy.

“Gardening reality is born with a hoe in the hand.” Sara Stein

Paul Alexander

ARTIST OF THE MONTH

AUGUST

DEBORAH BROAD

Oil & Acrylic Paintings

Myrtle Trace Ladies Coffee Klatch

Tuesday
September 16, 2008
10—12 noon at Clubhouse

PLEASE RSVP
to Liz Maass
at
347-3751

FALL / WINTER BIBLE STUDIES

Where: Clubhouse
When: Monday
Sep. 8, 2008
Time: 9:30 AM - 11:30 AM

Non-denominational
Studies of the Bible

Contact:
Sally Krause
347-6573

MYRTLE TRACE WEBSITE
www.myrtletracesc.org

MYRTLE TRACE ACTIVITIES

September 2008

Sunday	Monday	Tuesday	Wednesday	Thursday	Friday	Saturday
	1 9:30-11 Bible Study 12:30 Mah Jongg	2 1:00 Mah Jongg Duplic. Bridge Canasta 6:00 King's Poker 7:00 McNell's Poker	3 12:30 Bridge (Old Tricks) 6:00 King's Poker 6:30 Men's Poker	4 9-11 Crafters 10:00 Bowling 1:30 Scrabble 7:00 MTS MTG.	5 9:00 Line Dancing 1:00 Canasta Duplic. Bridge	6 9:30 Open Bowling
7 7:00 Game Night 3:30 Murder Mystery Rehearsal	8 9:30-11 Bible Study 12:30 Mah Jongg 4:00 ARC COM. 7:00 BEGINNER COMPUTER CLASS	9 10:00 PROP. COM. 1:00 Mah Jongg Duplic. Bridge Canasta 6:00 King's Poker 7:00 McNell's Poker	10 9:30 PHS. 8 COFFEE 12:30 Bridge (Easy Aces) 6:00 King's Poker 6:30 Men's Poker	11 9-11 Crafters 10:00 Bowling 1:30 Scrabble 7:00 Mah Jongg	12 9:00 Line Dancing 1:00 Canasta 7:00 Bingo	13 9:30 Open Bowling 7:30 Bridge
14 3-5pm GET AQUAINTED SOCIAL 7:00 Game Night	15 9:30-11 Bible Study 12:30 Mah Jongg 5:30 POT LUCK	16 10-12 MT LADIES COFFEE KLATCH 1:00 Mah Jongg Duplic. Bridge Canasta 6:00 King's Poker 7:00 McNell's Poker	17 9:00 MTHOA BOARD MTG. 12:30 Bridge (Old Tricks) 5:00 NEWCOMERS Bonfish Grill 6:00 King's Poker 6:30 Men's Poker	18 9-11 Crafters 10:00 Bowling 1:30 Scrabble 7:00 Mah Jongg	19 9:00 Line Dancing 1:00 Canasta Duplic. Bridge	20 9:30 Open Bowling
21 7:00 Game Night 3:30 Murder Mystery Rehearsal	22 9:30-11 Bible Study 12:30 Mah Jongg 4:00 ARC COM. 7:00 ACTIV. COM.	23 1:00 Mah Jongg Duplic. Bridge Canasta 3:00 Caregivers Grp 6:00 King's Poker 7:00 McNell's Poker	24 12:30 Bridge (Easy Aces) 6:00 King's Poker 6:30 Men's Poker	25 9-11 Crafters 10:00 Bowling 1:30 Scrabble 7:00 Mah Jongg	26 9:00 Line Dancing 1:00 Canasta	27 9:30 Open Bowling 7:30 Bridge
28 7:00 Game Night 3:30 Murder Mystery Rehearsal	29 9:30-11 Bible Study 12:30 Mah Jongg	30 1:00 Mah Jongg Duplic. Bridge Canasta 6:00 King's Poker 7:00 McNell's Poker	SWIMMERCISE - POOL M - F 8:00 - 8:45		EXERCISING - CLUBHOUSE M - F 7:45 - 9:00	